

SECTION A-A

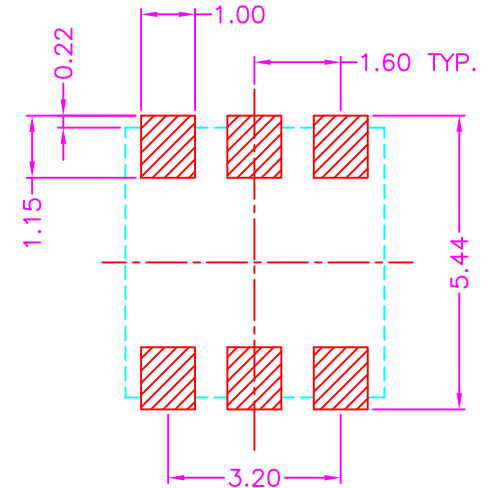
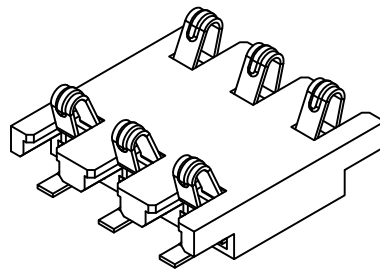
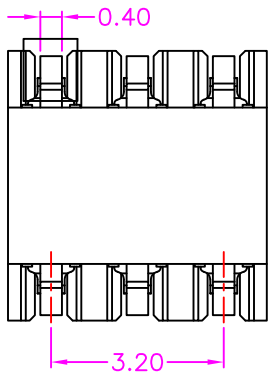
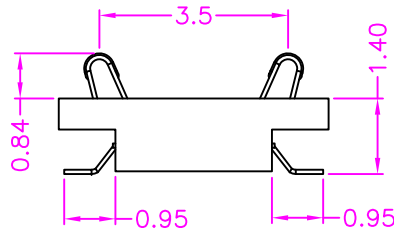
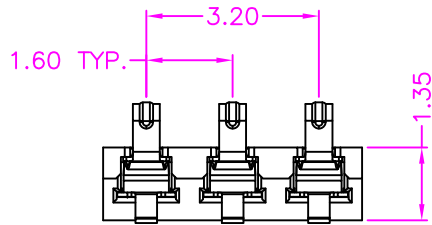

MATERIALS

HOUSING: LCP (UL 94V-0), BLACK
 TERMINAL: COPPER ALLOY, GOLD PLATED

SPECIFICATION

CURRENT RATING: 1 AMP MAX
 DIELECTRIC WITHSTANDING: 100V AC FOR ONE MINUTE
 CONTACT RESISTANCE: 30m OHMS MAX
 INSULATION RESISTANCE: 1000M OHMS MIN AT DC 500V
 OPERATION TEMPERATURE: -40°C~+85°C

PART NUMBER:

ABTNG - 0 6 * - 1 2 2

SERIES

NO. OF POS.

TAPE REEL PACKAGE

CONTACT PLATED OPTION

- 1. GOLD FLASH
- 3. 3u" GOLD
- 5. 5u" GOLD
- 6. 10u" GOLD
- 7. 15u" GOLD
- 9. 30u" GOLD