

1 2 3 4 5 6

A

A

B

B

C

C

D

D

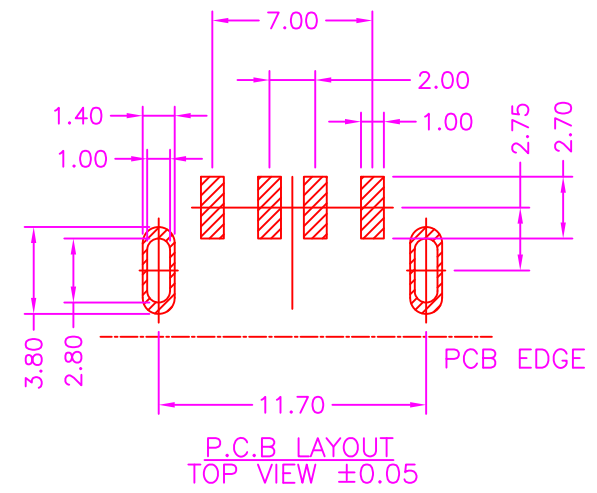
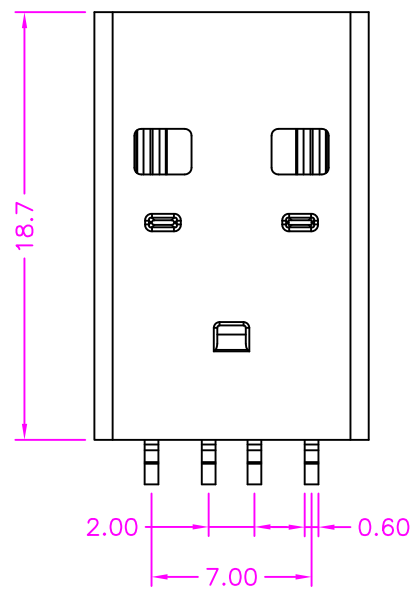
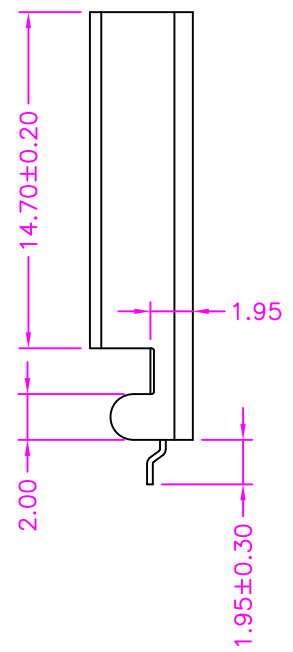
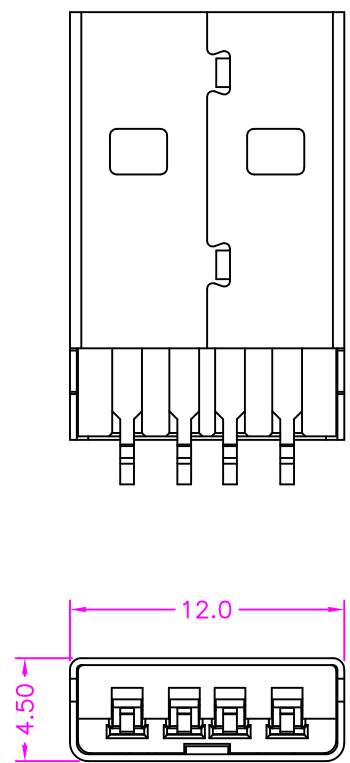

PART NUMBER:
BUSAD - 0 4 * T - 2 * 5 *

SERIES — NO. OF POS. — CONTACT PLATED OPTION — TIN PLATING ON SOLDER TAIL — HOUSING COLOR OPTION — PACKAGE OPTION

CONTACT PLATED OPTION:
 1: GOLD FLASH
 3: 3u" GOLD
 5: 5u" GOLD
 6: 10u" GOLD
 7: 15u" GOLD
 9: 30u" GOLD

HOUSING COLOR OPTION:
 BLANK: BLACK
 W: WHITE

PACKAGE OPTION:
 1: TRAY
 2: TAPE REEL

MATERIALS

HOUSING: LCP (UL 94V-0)
 SHELL: SPCC, NICKEL PLATING
 TERMINAL: COPPER ALLOY, GOLD PLATED ON CONTACT AREA
 TIN PLATING ON SOLDER TAIL

SPECIFICATION

VOLTAGE RATING: 30V MAX
 CURRENT RATING: 1.5 AMP MAX
 DIELECTRIC WITHSTANDING: 500V AC FOR ONE MINUTE
 CONTACT RESISTANCE: 30m OHMS MAX
 INSULATION RESISTANCE: 1000M OHMS MIN AT DC 500V
 OPERATION TEMPERATURE: -40°C~+85°C



TOLERANCES	
X.±0.40	.XX±0.20
.X±0.30	.XXX±0.10

REV.	A	DRAWN BY	Kiki 2023/3/23	TITLE	USB A TYPE, PCB MID MOUNT, SMT, METAL SHIELD, MALE				
		APPROVED BY	Lion 2023/3/23	DRAW NO.	BUSAD-005	UNIT	MM	Sheet	1/1

DRAWN BY	Kiki 2023/3/23	TITLE	USB A TYPE, PCB MID MOUNT, SMT, METAL SHIELD, MALE				
APPROVED BY	Lion 2023/3/23	DRAW NO.	BUSAD-005	UNIT	MM	Sheet	1/1

1 2 3 4 5 6