

MATERIALS

HOUSING: TEFLON (UL 94V-0), WHITE
 SHELL: COPPER ALLOY, GOLD PLATING
 TERMINAL: COPPER ALLOY, GOLD PLATED

PART NUMBER:

RSABE - 5 * 1 - 1 4 7

SERIES — 50 OHM — BAG PACKAGE

CONTACT PLATED OPTION

- 1: GOLD FLASH
- 3: 3u" GOLD
- 5: 5u" GOLD
- 6: 10u" GOLD
- 9: 30u" GOLD

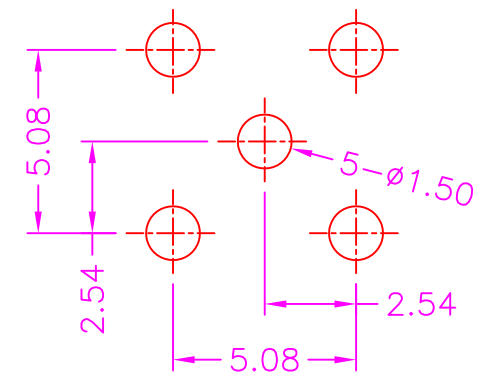

**P.C.B. LAYOUT
 TOP VIEW ±0.05**