

MATERIALS

HOUSING: THERMOPLASTIC (UL 94V-0), BLUE
 SHELL: SPCC, NICKEL PLATING
 BOARDLOCK: SPCC, TIN PLATING
 SCREW: STEEL, NICKEL PLATING
 TERMINAL: COPPER ALLOY, GOLD PLATED ON CONTACT AREA
 TIN PLATING ON SOLDER TAIL

SPECIFICATION

CURRENT RATING: 5 AMP MAX
 DIELECTRIC WITHSTANDING: 1000V AC FOR ONE MINUTE
 CONTACT RESISTANCE: 30m OHMS MAX
 INSULATION RESISTANCE: 1000M OHMS MIN AT DC 500V
 OPERATION TEMPERATURE: -55°C~+105°C

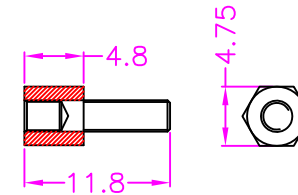
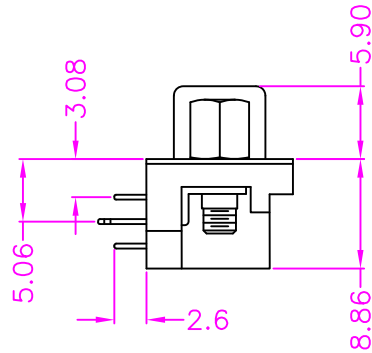
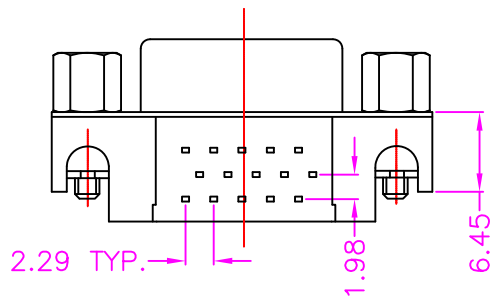
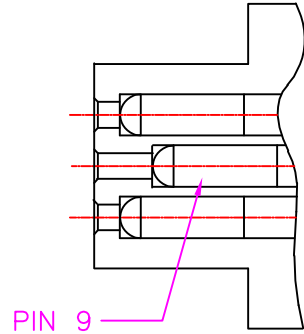

RECOMMENDED SCREW

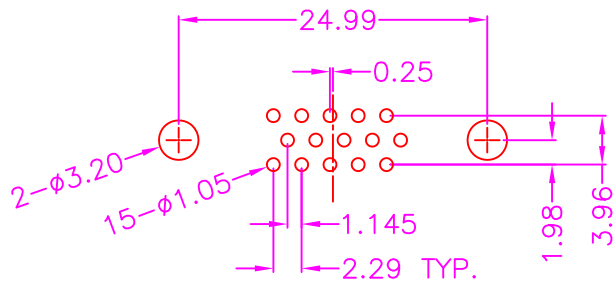

**P.C.B LAYOUT
TOP VIEW ±0.05**

PART NUMBER:

BDBHD - 1 5 * T 4 - 1 1 1 *

- SERIES
- NO OF POS.
- CONTACT PLATED OPTION
- HOUSING COLOR OPTION
BLANK: BLACK
BL: BLUE
- TRAY PACKAGE
- W/O RIVETED & SCREW LOCK
- TIN PLATING ON SOLDER TAIL