

MATERIALS

HOUSING: HI-TEMP. PLASTIC (UL 94V-0)
 SHELL: COPPER ALLOY OR SPCC, NICKEL PLATING
 TERMINAL: COPPER ALLOY, GOLD PLATED ON CONTACT AREA
 TIN PLATING ON SOLDER TAIL

SPECIFICATION

CURRENT RATING: 0.5 AMP MAX
 DIELECTRIC WITHSTANDING: 500V AC FOR ONE MINUTE
 CONTACT RESISTANCE: 30m OHMS MAX
 INSULATION RESISTANCE: 100M OHMS MIN AT DC 500V
 OPERATION TEMPERATURE: -20°C~+85°C

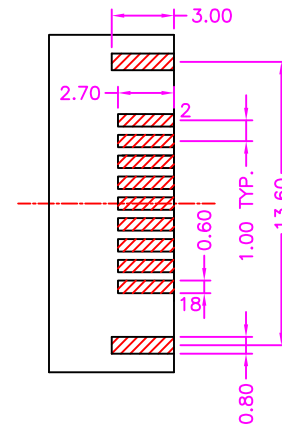
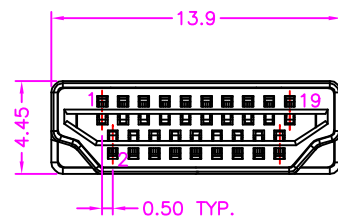
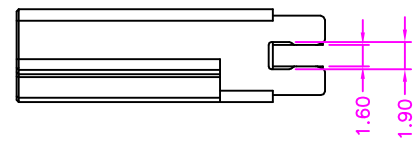

PART NUMBER:

BHDAS - 1 9 * T * - 2 * 2

SERIES ————
 NO. OF POS. ————
 CONTACT PLATED OPTION ————
 PACKAGE OPTION
 1: TRAY
 4: BAG
 SHELL OPTION
 BLANK: COPPER ALLOY
 S: SPCC
 TIN PLATING ON SOLDER TAIL

CONTACT PLATED OPTION
 1: GOLD FLASH
 3: 3u" GOLD
 5: 5u" GOLD
 7: 15u" GOLD
 9: 30u" GOLD

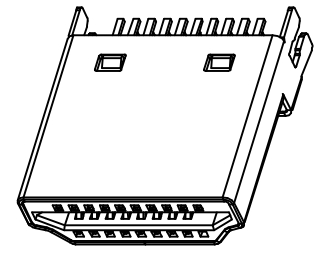
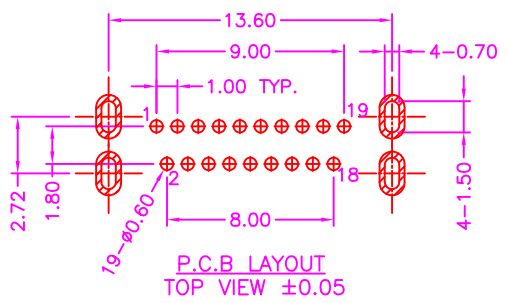

STRADDLE TYPE TOP VIEW
 P.C.B LAYOUT ±0.05